

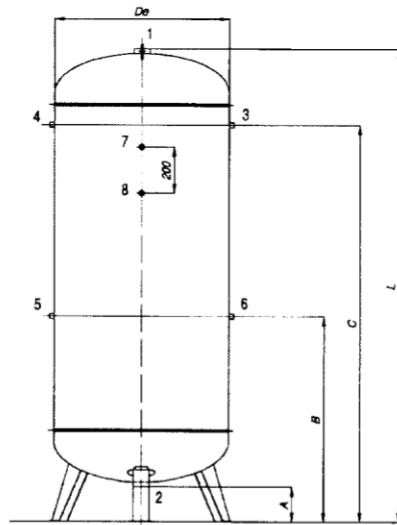

Serbatoi verticali

Serie VSA con staffe



Caratteristiche generali

Capacità: 50 - 3000 Lt.

Pressione: 11 - 16 Bar

Collaudo: CE87/404 - 97/23 CE (PED)

Materiale: acciaio al carbonio

Trattamento superficiale: grezzo, verniciato azzurro RAL 5015 (a richiesta zincato a caldo)

Serbatoi verticali standard 11/12 Bar

Capacità	Codice		Pressione Bar	A mm	B mm	C mm	DE mm	L mm	1 in	2 in	3 in	4 in	5 in	6 in	7 in	8 in
	Grezzo	Verniciato														
50 Lt.	50-VSA/G-11-CE	50-VSA/V-11-CE	11	126	288	770	286	932	1/2"	1/2"	N.D.	1/2"	N.D.	1/2"	N.D.	N.D.
100 Lt.	100-VSA/G-11-CE	100-VSA/V-11-CE	11	119	311	1083	350	1274	1/2"	1/2"	N.D.	1/2"	N.D.	1/2"	N.D.	N.D.
200 Lt.	200-VSA/G-11-CE	200-VSA/V-11-CE	11	175	398	1223	446	1570	1/2"	1/2"	N.D.	1"	N.D.	1"	3/8"	3/8"
270 Lt.	270-VSA/G-11-CE	270-VSA/V-11-CE	11	175	600	1305	500	1664	1/2"	1/2"	1"	N.D.	1"	1"	3/8"	N.D.
500 Lt.	500-VSA/G-11-CE	500-VSA/V-11-CE	11	155	785	1665	600	2050	2"	2"	2"	2"	2"	2"	3/8"	N.D.
720 Lt.	720-VSA/G-11-CE	720-VSA/V-11-CE	11	150	880	1705	750	2030	2"	2"	2"	2"	2"	2"	3/8"	3/8"
900 Lt.	900-VSA/G-11-CE	900-VSA/V-11-CE	11	140	875	1805	800	2140	2"	2"	1"1/2"	1"1/2"	1"1/2"	1"1/2"	3/8"	3/8"
1000 Lt.	1000-VSA/G-12-PED	1000-VSA/V-12-PED	12	135	765	1705	800	2335	2"	2"	2"	2"	2"	2"	1/2"	3/8"
2000 Lt.	2000-VSA/G-12-PED	2000-VSA/V-12-PED	12	195	750	1955	1100	2485	2"	2"	2"	2"	2"	2"	1/2"	1/2"
3000 Lt.	3000-VSA/G-12-PED	3000-VSA/V-12-PED	12	140	830	2245	1200	2980	2"	2"	2"	2"	2"	2"	3/8"	1/2"

Serbatoi verticali speciali 15/16 Bar

Capacità	Codice		Pressione Bar	A mm	B mm	C mm	DE mm	L mm	1 in	2 in	3 in	4 in	5 in	6 in	7 in	8 in
	Grezzo	Verniciato														
50 Lt.	50-VSA/G-15-CE	50-VSA/V-15-CE	15	145	687	787	305	929	1/2"	1/2"	3/8"	N.D.	N.D.	3/8"	N.D.	N.D.
100 Lt.	100-VSA/G-16-CE	100-VSA/V-16-CE	16	140	298	998	370	1156	1/2"	1/2"	N.D.	3/4"	N.D.	3/4"	3/8"	3/8"
150 Lt.	150-VSA/G-16-CE	150-VSA/V-16-CE	16	190	385	1210	396	1430	1/2"	1/2"	N.D.	1"	N.D.	1"	3/8"	3/8"
200 Lt.	200-VSA/G-15-CE	200-VSA/V-15-CE	15	190	397	1222	446	1554	1/2"	1/2"	N.D.	1"	N.D.	1"	3/8"	3/8"
270 Lt.	270-VSA/G-16-PED	270-VSA/V-16-PED	16	190	599	1304	500	1648	1/2"	1/2"	1"	N.D.	1"	1"	3/8"	N.D.
500 Lt.	500-VSA/G-15-PED	500-VSA/V-15-PED	15	155	775	1560	600	2055	1/2"	1/2"	1"	1"	1"	1"	3/8"	N.D.
1000 Lt.	1000-VSA/G-16-PED	1000-VSA/V-16-PED	16	135	765	1705	800	2335	2"	2"	2"	2"	2"	2"	3/8"	3/8"
2000 Lt.	2000-VSA/G-16-PED	2000-VSA/V-16-PED	16	170	770	2185	1000	2740	2"	2"	2"	2"	2"	2"	1/2"	1/2"