

Raccordi accessori Sprint® Serie S2000

Attacchi: G1/8, G1/4, G3/8, G1/2
R1/8, R1/4, R3/8, R1/2



I raccordi accessori Sprint® sono disponibili in 14 diversi modelli e riguardano esclusivamente i filetti conici. Il particolare sistema di tenuta, già alloggiato sul filetto conico, rende superfluo l'uso di collanti liquidi o del nastro PTFE evitando all'operatore perdite di tempo in fase di montaggio.

Grazie a questo sistema di tenuta è possibile montare e smontare più volte il raccordo senza pregiudicare la tenuta sul filetto, garantendone allo stesso tempo l'estrema pulizia.

CARATTERISTICHE GENERALI

Materiale	OT nichelato e PTFE
Filettature	GAS conico ISO 7 (BSPT) GAS cilindrico ISO 228 (BSP)
Pressione	40 bar
Fluido	Aria compressa ed altri fluidi a bassa pressione.
Temperatura	-40°C + 120°C

Raccordi Accessori Sprint®

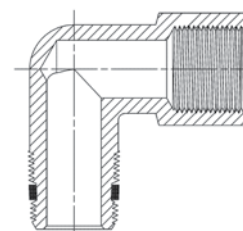

Raccordi Mod. S2500

Sprint®

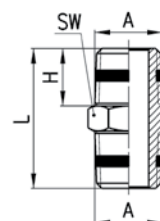

INGOMBRI					
Mod.	A	H	L	SW	Peso (g)
S2500 1/8	R1/8	7,5	19,5	12	8
S2500 1/4	R1/4	11	27	14	15
S2500 3/8	R3/8	11,5	28	17	21
S2500 1/2	R1/2	14	33,5	22	39

Raccordi Mod. S2530

Sprint®

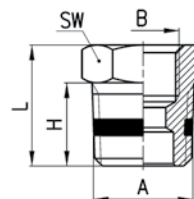

INGOMBRI						
Mod.	A	B	H	L	SW	Peso (g)
S2530 1/4-1/8	R1/4	G1/8	11	16	14	9
S2530 3/8-1/8	R3/8	G1/8	11,5	16,5	17	16
S2530 1/2-1/8	R1/2	G1/8	14	19,5	22	13
S2530 3/8-1/4	R3/8	G1/4	11,5	16,5	17	33
S2530 1/2-1/4	R1/2	G1/4	14	19,5	22	32
S2530 1/2-3/8	R1/2	G3/8	14	19,5	22	22

Raccordi Mod. S2520

Sprint®

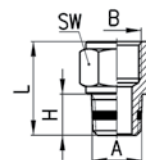

INGOMBRI						
Mod.	A	B	H	L	SW	Peso (g)
S2520 1/8-1/8	R1/8	G1/8	7,5	17,5	13	11
S2520 1/8-1/4	R1/8	G1/4	7,5	19	17	15
S2520 1/8-3/8	R1/8	G3/8	7,5	20	20	19
S2520 1/4-1/4	R1/4	G1/4	11	22,5	17	17
S2520 1/4-3/8	R1/4	G3/8	11	23,5	20	33
S2520 1/4-1/2	R1/4	G1/2	11	27,5	24	34
S2520 3/8-3/8	R3/8	G3/8	11,5	24	20	36
S2520 3/8-1/2	R3/8	G1/2	11,5	28	24	56
S2520 1/2-1/2	R1/2	G1/2	14	30,5	24	41

Raccordi Mod. S2510

Sprint®

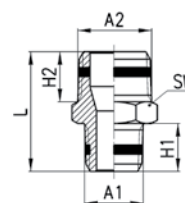

INGOMBRI							
Mod.	A1	A2	H1	H2	L	SW	Peso (g)
S2510 1/8-1/4	R1/8	R1/4	7,5	11	23,5	14	14
S2510 1/8-3/8	R1/8	R3/8	7,5	11,5	24	17	22
S2510 1/4-3/8	R1/4	R3/8	11	11,5	27,5	17	19
S2510 1/4-1/2	R1/4	R1/2	11	14	30,5	22	33
S2510 3/8-1/2	R3/8	R1/2	11,5	14	31	22	36

Raccordi Mod. 2541

Sprint®



Modello girevole

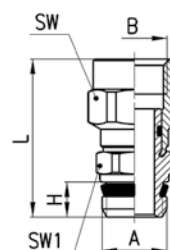

INGOMBRI							
Mod.	A	B	H	L	SW	SW1	Peso (g)
2541 1/8-1/8	G1/8	G1/8	5,5	28	13	14	17
2541 1/4-1/4	G1/4	G1/4	7	31,5	17	14	26
2541 3/8-3/8	G3/8	G3/8	8	34	20	19	39

Raccordi Mod. S2010

Sprint®

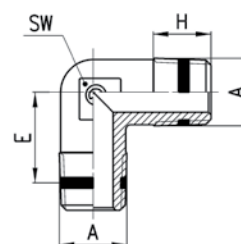

INGOMBRI					
Mod.	A	E	H	SW	Peso (g)
S2010 1/8	R1/8	11,5	7,5	9	9
S2010 1/4	R1/4	13,5	11	12	17
S2010 3/8	R3/8	15,5	11,5	14	25
S2010 1/2	R1/2	16	14	16	47

Raccordi Mod. S2020

Sprint®

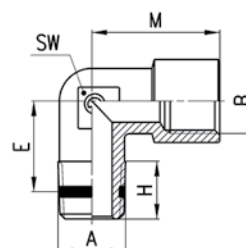

INGOMBRI							
Mod.	A	B	E	H	M	SW	Peso (g)
S2020 1/8-1/8	R1/8	G1/8	11,5	8,5	19	11	16
S2020 1/4-1/4	R1/4	G1/4	15	11	23	13	27
S2020 3/8-3/8	R3/8	G3/8	15	11,5	25	15	33
S2020 1/2-1/2	R1/2	G1/2	17,5	14	31,5	20	62

Raccordi Mod. S2050

Sprint®

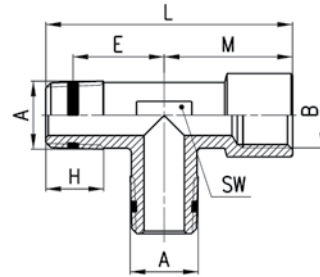

INGOMBRI								
Mod.	A	B	E	H	L	M	SW	Peso (g)
S2050 1/8-1/8	R1/8	G1/8	11,5	8,5	37	19	12	14
S2050 1/4-1/4	R1/4	G1/4	15	11	46	23	13	44
S2050 3/8-3/8	R3/8	G3/8	15	11,5	48,5	25	16	59
S2050 1/2-1/2	R1/2	G1/2	17,5	14	60,5	31,5	20	81

Raccordi Mod. S2060

Sprint®

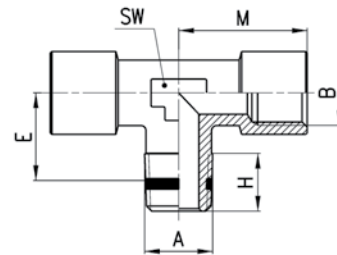

INGOMBRI								
Mod.	A	B	E	H	M	SW	Peso (g)	
S2060 1/8-1/8	R1/8	G1/8	11,5	8,5	19	12	31	
S2060 1/4-1/4	R1/4	G1/4	15	11	23	13	38	
S2060 3/8-3/8	R3/8	G3/8	15	11,5	25	16	51	
S2060 1/2-1/2	R1/2	G1/2	17,5	14	31,5	20	88	

Raccordi Mod. S2070

Sprint®

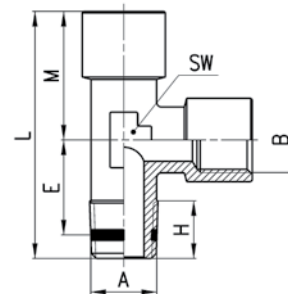

INGOMBRI								
Mod.	A	B	E	H	L	M	SW	Peso (g)
S2070 1/8-1/8	R1/8	G1/8	11,5	8,5	37	19	12	30
S2070 1/4-1/4	R1/4	G1/4	15	11	46	23	13	36
S2070 3/8-3/8	R3/8	G3/8	15	11,5	48,5	25	16	51
S2070 1/2-1/2	R1/2	G1/2	17,5	14	60,5	31,5	20	89

Raccordi Mod. S2080

Sprint®

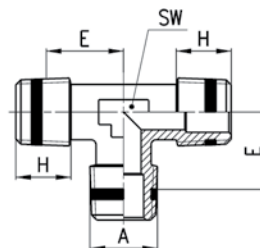
INGOMBRI

Mod.	A	E	H	SW	Peso (g)
S2080 1/8	R1/8	11,5	7,5	9	14
S2080 1/4	R1/4	13,5	11	12	31
S2080 3/8	R3/8	15,5	11,5	14	50
S2080 1/2	R1/2	16	14	16	63

Raccordi Mod. S2090

Sprint®

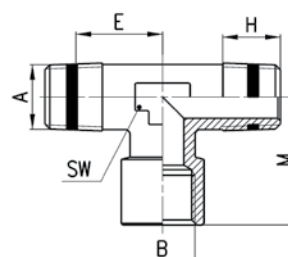
INGOMBRI

Mod.	A	B	E	H	M	SW	Peso (g)
S2090 1/8-1/8	R1/8	G1/8	11,5	8,5	19	12	22
S2090 1/4-1/4	R1/4	G1/4	15	11	23	13	16
S2090 3/8-3/8	R3/8	G3/8	15	11,5	25	16	59
S2090 1/2-1/2	R1/2	G1/2	17,5	14	31,5	20	80

Raccordi Mod. 2612 M7 e Mod. S2610

Sprint®

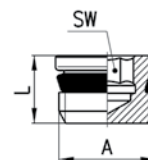

Nuovo modello

INGOMBRI

Mod.	A	L	SW	Peso (g)
2612 M7	M7	7	4	2 *
S2610 1/8	G1/8	7,5	4	3
S2610 1/4	G1/4	9	6	6
S2610 3/8	G3/8	10	8	12
S2610 1/2	G1/2	11	10	21

* con O-ring montato

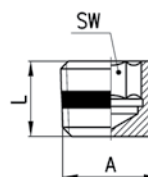
Raccordi Mod. S2615

Sprint®

INGOMBRI

Mod.	A	L	SW	Peso (g)
S2615 1/8	R1/8	8	5	2
S2615 1/4	R1/4	10	7	6
S2615 3/8	R3/8	10	8	12