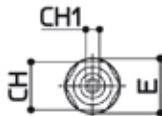
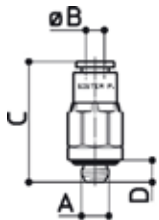

FISSO DIRITTO METRICO+OR
 FIXED METRIC STRAIGHT+OR
 DROIT FIXE METRIQUE+OR
 GERADER EINSCHRAUBANSCHLUSS+OR

CODICE	A	B	C	D	E	F	G	CH	CH1	GR
105048	M5	4	22	4	10			9	2,5	6
106048	M6x0.75	4	23	5	10			9	2,5	6
10061048	M6x1	4	23	5	10			9	2,5	6
108140 *	M8x1	4	22	6	10.4			9		6
105058	M5	5	22	4	11			10	2,5	7
105068	M5	6	26	4	13			12	2,5	13
106168	M6x1	6	26	5	13			12	2,5	14
10081268	M8x1.25	6	27.5	6	13			12	4	12
101168	M10x1	6	24.5	6	14.3			13	4	12
102168	M12x1	6	26	8	17.5			16	4	19
10121268	M12x1.25	6	26	8	17.5			16	4	19
101268	M12x1.5	6	26	8	17.5			16	4	18
10081288	M8x1.25	8	29.5	6	15.5			14		17
101188	M10x1	8	29.5	6	15.5			14	5	18
10121088	M12x1	8	29	8	17.5			16	6	17
10121288	M12x1.25	8	29	8	17.5			16	6	20
101288	M12x1.5	8	29	8	17.5			16	6	19