

# RACCORDERIA SERIE K

K LINE FITTINGS - RACCORDS SERIE K - K BAUREIHE

## K10T

### FISSO DIRITTO RIDOTTO NPT SERIE-K

FIXED REDUCED STRAIGHT NPT K-SERIES

DROIT FIXE NPT REDUIT SERIE-K

GERADER EINSCHRAUBANSCHLUSS+OR Serie-K

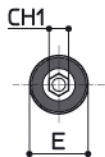
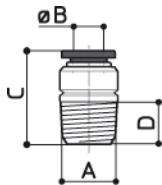

CODICE	A	B	C	D	E	F	G	CH	CH1	GR
<b>K10TK630</b>	N1/8	6.35(1/4)	21.8	7.5	12				4	7
<b>K10TX630</b>	N1/4	6.35(1/4)	20.8	9	14				5	10
<b>K10TK790</b>	N1/8	7.93(5/16)	26.2	7.5	14				5	10
<b>K10TX790</b>	N1/4	7.93(5/16)	24	9	14				6	10
<b>K10TY790</b>	N3/8	7.93(5/16)	23.8	10.5	17				6	18
<b>K10TX950</b>	N1/4	9.52(3/8)	30	9	17				5	17
<b>K10TY950</b>	N3/8	9.52(3/8)	28.6	10.5	17				8	20
<b>K10TZ950</b>	N1/2	9.52(3/8)	27.5	12	21				8	31
<b>K10TX270</b>	N1/4	12.7(1/2)	31.7	9	19				6	20
<b>K10TY270</b>	N3/8	12.7(1/2)	30.2	10.5	19				8	21
<b>K10TZ270</b>	N1/2	12.7(1/2)	29.1	12	21				10	29