

## 700/316L

Curva 3D 90° da tubo saldato  
Welded elbow 3D 90°  
Rohrbogen Geschweisst BA3 90°  
Courbe 3D 90° à souder  
Codo 3D 90°

Norma: EN 10253-3 (DIN 2605)

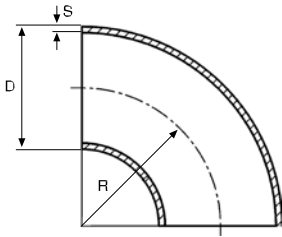

AISI 316L / W. 1.4404

### SPESSORE / THICKNESS 2 mm

Codice Code	DN	DN inch	D mm	S mm	R mm	gr	
700213316	15	1/2"	21,3	2	28	40	10
700269316	20	3/4"	26,9	2	29	60	10
700337316	25	1"	33,7	2	38	100	10
700424316	32	1"1/4	42,4	2	48	155	10
700483316	40	1"1/2	48,3	2	57	215	10
700603316	50	2"	60,3	2	76	350	10
700761316	65	2"1/2	76,1	2	95	560	5
700889316	80	3"	88,9	2	114	810	5
700101316	90	3"1/2	101,6	2	133,5	954	4
700114316	100	4"	114,3	2	152	1300	4
700139316	125	5"	139,7	2	190	2100	3
700168316	150	6"	168,3	2	229	2840	1
700219316	200	8"	219,1	2	305	5150	1

#### Tolleranze dimensionali / Dimensional tolerances

D = il maggiore tra / the bigger between  $\pm 1 \% \text{ bx } D / \pm 0,5 \text{ mm}$

S =  $-12,5\% \times S / +20 \% \times S$

R =  $\pm 2 \text{ mm}$

## 701/316L

Curva 3D 90° da tubo saldato  
Welded elbow 3D 90°  
Rohrbogen Geschweisst BA3 90°  
Courbe 3D 90° à souder  
Codo 3D 90°

Norma: EN 10253-3 (DIN 2605)

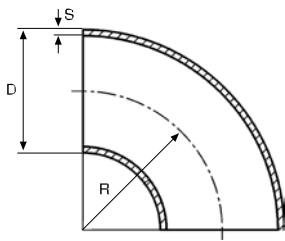

AISI 316L / W. 1.4404

### SPESSORE / THICKNESS 3 mm

Codice Code	DN	DN inch	D mm	S mm	R mm	gr	
701337316	25	1"	33,7	3	38	140	10
701424316	32	1"1/4	42,4	3	48	210	10
701483316	40	1"1/2	48,3	3	57	318	10
701603316	50	2"	60,3	3	76	500	10
701761316	65	2"1/2	76,1	3	95	640	5
701889316	80	3"	88,9	3	114	1130	5
701101316	90	3"1/2	101,6	3	133,5	1524	4
701114316	100	4"	114,3	3	152	1575	4
701139316	125	5"	139,7	3	190	3135	3
701168316	150	6"	168,3	3	229	4390	1
701219316	200	8"	219,1	3	305	7365	1

#### Tolleranze dimensionali / Dimensional tolerances

D = il maggiore tra / the bigger between  $\pm 1 \% \times D / \pm 0,5 \text{ mm}$

S =  $-12,5\% \times S / +20 \% \times S$

R =  $\pm 2 \text{ mm}$

## 706/316L

Curva metrica 90° da tubo salda  
Metric welded elbow 90°  
Metrische geschweisste Rohrbo  
Courbe metrique 90° à souder  
Codo 90° medida métrica de tub

Norma: EN 10253-3 (DIN 2605)

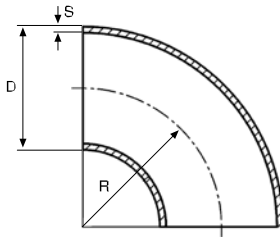

AISI 316L / W. 1.4404

### SPESSORE / THICKNESS 1,5 mm

Codice Code	D mm	S mm	R mm	gr		
706180316	18	1,5	25	30	10	
706200316	20	1,5	30	30	10	
706230316	23	1,5	35	40	10	
706250316	25	1,5	37	50	10	
706280316	28	1,5	40	60	10	
706300316	30	1,5	45	80	10	
706330316	33	1,5	50	80	10	
706350316	35	1,5	52,5	90	10	
706380316	38	1,5	55	110	10	
706400316	40	1,5	60	130	10	
706430316	43	1,5	65	150	10	
706508316	50,8	1,5	76	220	10	
706530316	53	1,5	80	250	10	
706635316	63,5	1,5	95	320	10	
706700316	70	1,5	92	500	5	
706730316	73	1,5	110	530	5	

## 707/316L

Curva metrica 90° da tubo sald  
 Metric welded elbow 90°  
 Metrische geschweisste Rohrbo  
 Courbe metrique 90° à souder  
 Codo 90° medida métrica de tu

Norma: EN 10253-3 (DIN 2605)

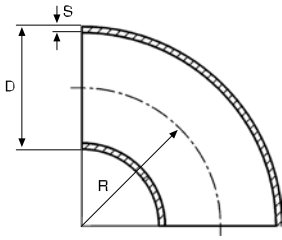

AISI 316L / W. 1.4404

### SPESSORE / THICKNESS 2 mm

Codice Code	D mm	S mm	R mm	gr		
707200316	20	2	30	40	10	
707250316	25	2	37	60	10	
707300316	30	2	45	100	10	
707380316	38	2	55	140	10	
707400316	40	2	60	180	10	
707445316	44,5	2	65	200	10	
707500316	50	2	71	310	5	
707540316	54	2	80	330	5	
707570316	57	2	85,5	400	5	
707700316	70	2	92	460	5	
707840316	84	2	125	830	3	
707104316	104	2	155	1190	3	
707108316	108	2	142,5	1500	3	
707129316	129	2	190	2000	2	